

Brooklyn Way

West Drayton • Middlesex • UB7 7PD

PCM: £2,700 PCM



coopers
est 1986

Presented to the market, this three bedroom semi detached house located in West Drayton. On the ground floor is the entrance hallway, two reception rooms, the modern kitchen is equipped with fitted appliances and breakfast bar, with skylights and french doors providing a source of natural light. There is also a downstairs three piece shower room. Upstairs there are three generously sized bedrooms, the master with bay window, finally there is the equally spacious contemporary three piece family bathroom. This property is close by to West Drayton Station, Stockley Park and easy access to the M4/ M40.

- Three Bedrooms
- Semi Detached House
- Perfect Family House
- Close to the Elizabeth Line
- Rear Garden
- Two Reception Rooms
- Cul-de-sac Location
- Close to M25/M40
- Garage
- Close to Stockley Park

Available Date
28th November 2025

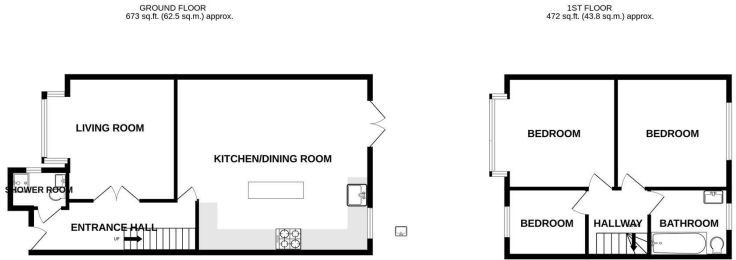

TOTAL FLOOR AREA: 1145 sq.ft. (106.3 sq.m.) approx.
Whilst every attempt has been made to ensure the accuracy of the floorplan contained herein, measurements of rooms, corridors, stairs and any other parts are approximate and no responsibility is taken for any error, omission or misstatement. This plan is for illustrative purposes only and should be used as such by any prospective purchaser. The structure, layout and appliances shown have not been tested and no guarantee as to their operability or efficiency can be given.
Made with floorplan 10004



01895 230 103
109 Hillingdon Hill, Hillingdon Village,
Middlesex, UB10 0JQ
propertymanagement@coopersresidential.co.uk
CoopersResidential.co.uk

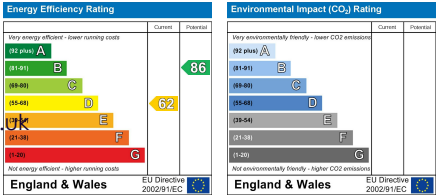

Important Notice: These particulars, whilst believed to be accurate are set out as a general outline only for guidance and do not constitute any part of an offer or contract. Intending purchasers should not rely on them as statements or representation of fact, but must satisfy themselves by inspection or otherwise has the authority to make or give any representation or warranty in respect of the property.